

INSTALLING AIR FILTER WITH AIR PLENUM (cont.)

5. Install the assembled air plenum to the installed stays with the supplied eight (8) screws.

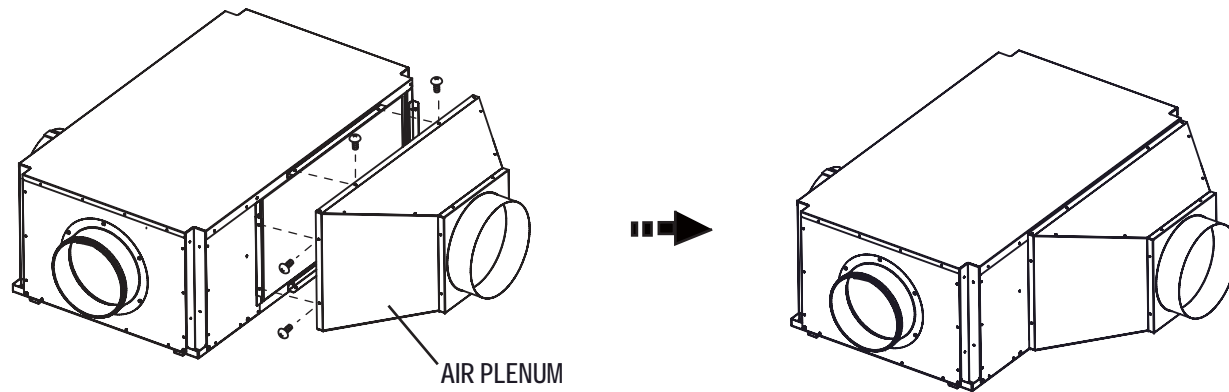

REMOVING AIR FILTER WITH AIR PLENUM

1. Disconnect the power to the unit.
2. Remove eight (8) screws and remove the air plenum as shown below.

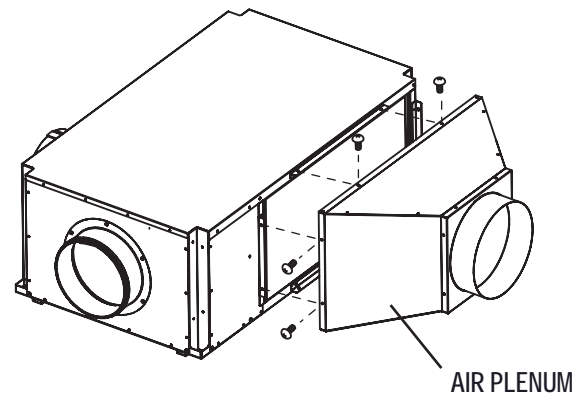

3. Hold the filter tap and lift the air filter upward from the bottom, then pull outward from the unit.

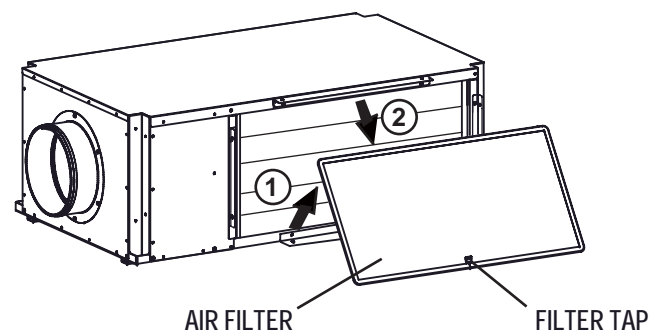

INSTALLATION MANUAL

Condenser Intake Air Filter Kit (Part No. 484409-0130)

FOR CM 25

Production Period: From October 2009 (1009)

INVENTORY

The condenser intake air filter kit consists of the following parts and quantities indicated in parenthesis.

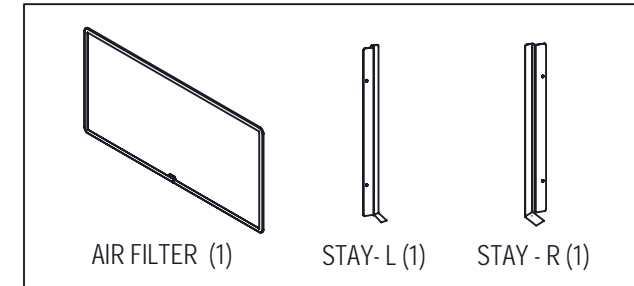

INSTALLING AIR FILTER

1. Disconnect the power to the unit.
2. Remove four (4) screws from the condenser intake of the unit as shown below.

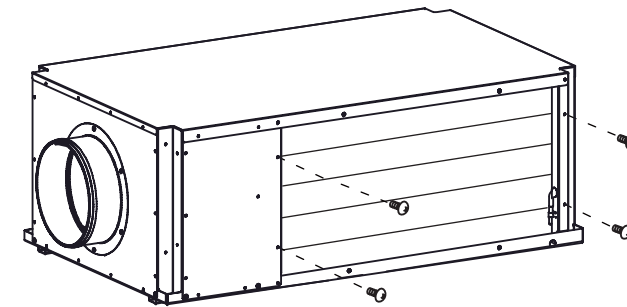

3. Install Stay - L and Stay - R with four (4) screws which were previously removed.

Note: Be careful not to damage the thermistor when installing Stay - R.

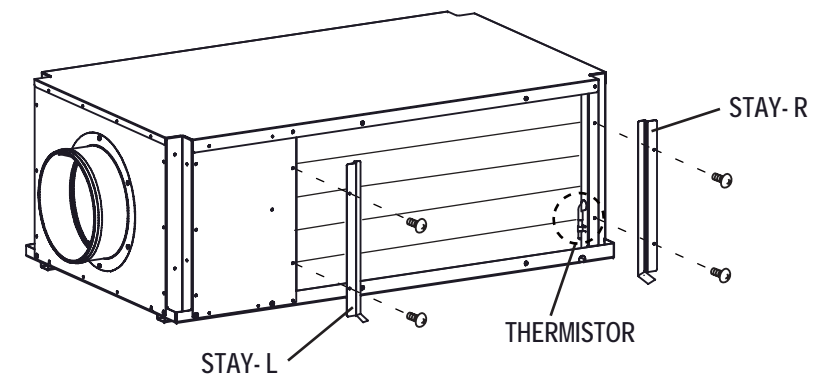

INSTALLING AIR FILTER (cont.)

4. Insert the air filter into the condenser intake of the unit, and make sure the filter tap is located at the bottom side.

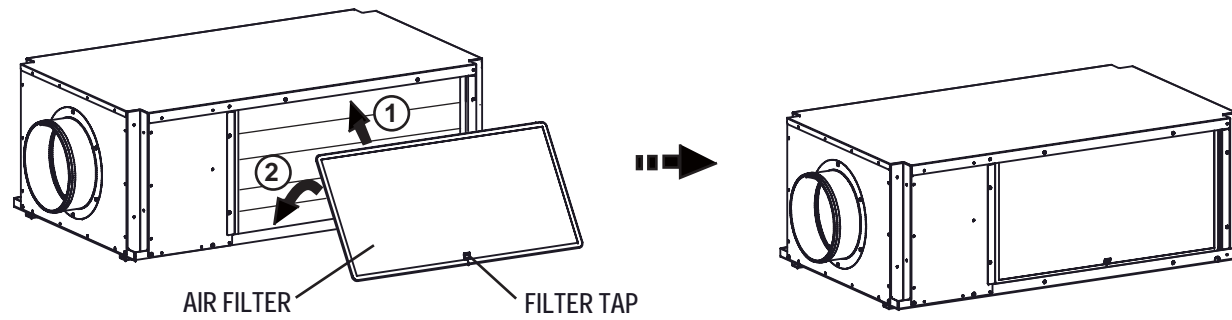

CLEANING AIR FILTER

Dirty air filter can reduce air output resulting in a decrease in cooling capacity. To avoid this problem, the condenser intake air filter should be cleaned once a month. If the CM 25 is used in a dusty environment, more frequent cleaning may be required such as once a week.

Removing Air Filter

1. Disconnect the power to the unit.
2. Hold the filter tap and lift the air filter upward from the bottom, then pull outward from the unit.

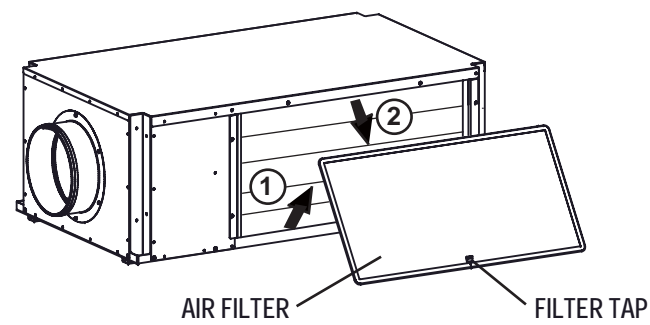

Cleaning Air Filter Element

1. Remove dust from the element with a vacuum cleaner, or rinse in cold or lukewarm water. If the element is extremely dirty, wash with a neutral detergent.
2. After the element has been cleaned, rinse with clean running water, allow the element to dry, and then reinstall to the unit.

INSTALLING AIR FILTER WITH AIR PLENUM

(If purchased with Condenser Intake Air Plenum Kit Part No. 484409-0240.)

1. Disconnect the power to the unit.
2. Remove eight (8) screws from the condenser intake of the unit as shown below.

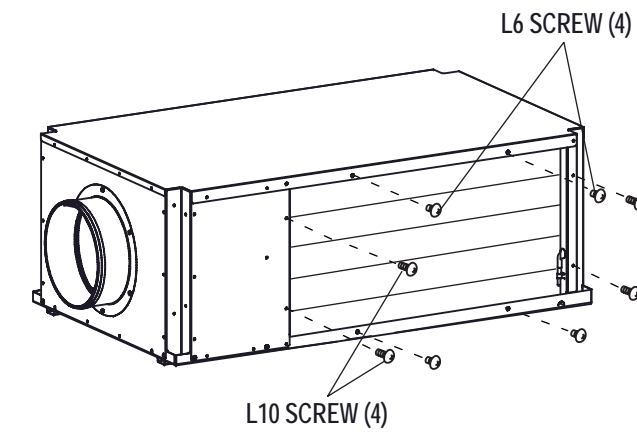

3. Install air filter stays and air plenum stays together as shown below.

*Note: 1. Make sure that the extruded holes of the air plenum stays are in the position as shown in View A.
2. Be careful not to damage the thermistor when installing Air Filter Stay - R with Air Plenum Stay - A.*

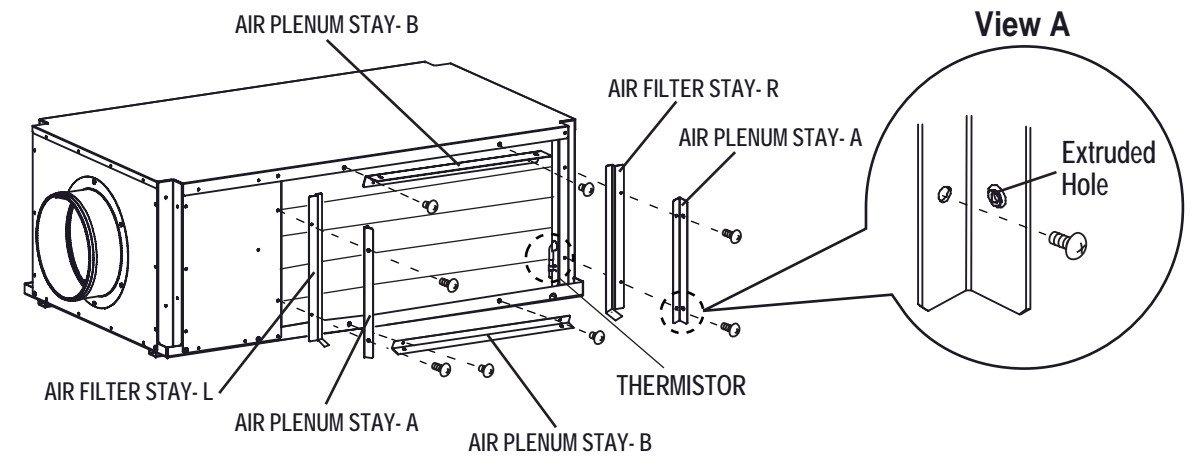

4. Insert the air filter into the condenser intake of the unit, and make sure the filter tap is located at the bottom side.

