

INSTALLATION MANUAL

Condenser Intake Air Plenum Kit (Part No. 481769-0240)

FOR CM 25

Production Period: From October 2009 (1009)

INVENTORY

The condenser intake air plenum kit consists of the following parts and quantities indicated in parenthesis.

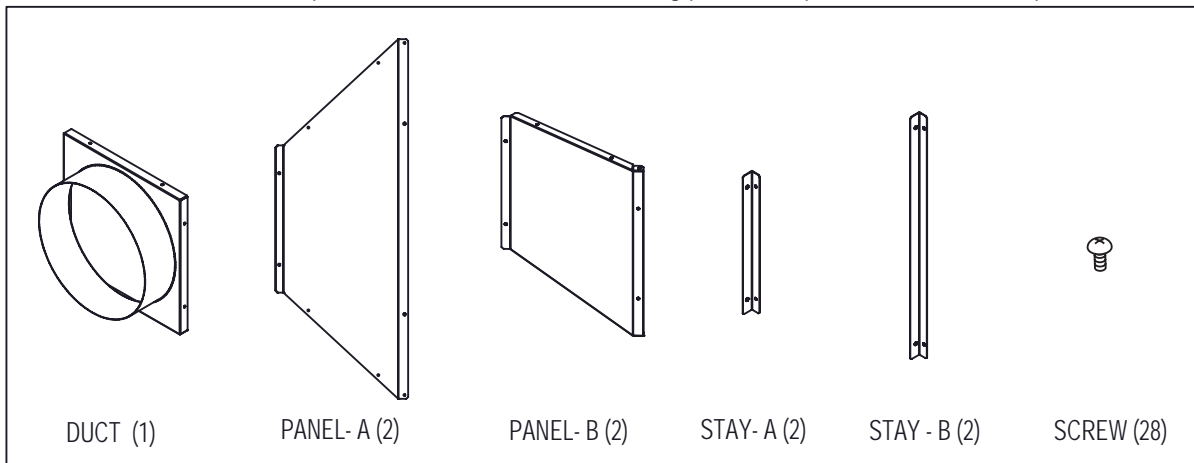

INSTALLATION PROCEDURE

Assembling Air Plenum

Assemble the air plenum with the supplied twenty (20) screws.

⚠ CAUTION: Watch out for sharp edges on the parts.

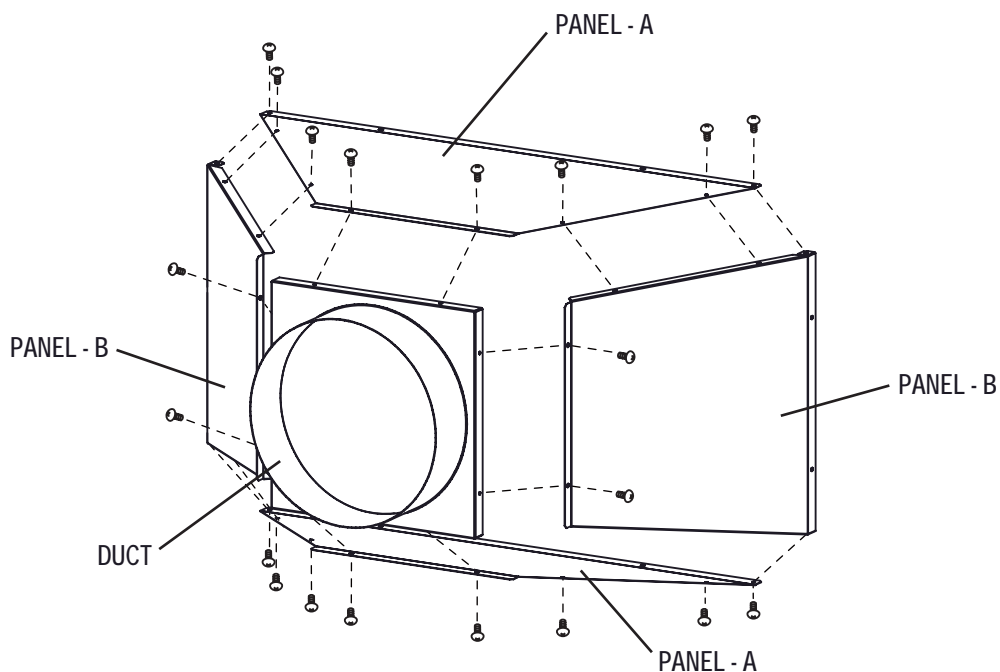

INSTALLATION PROCEDURE (cont.)

Installing Air Plenum

1. Disconnect the power to the unit.
2. Remove eight (8) screws from the condenser intake of the unit as shown.

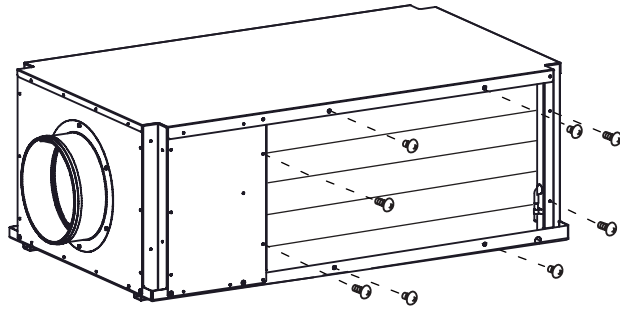

3. Install both Stay - A with four (4) L10 screws and both Stay - B with four (4) L6 screws which were previously removed.

*Note: 1. Make sure that the extruded holes of the stays are in the position as shown in View A.
2. Be careful not to damage the thermistor when installing the Stay - A.*

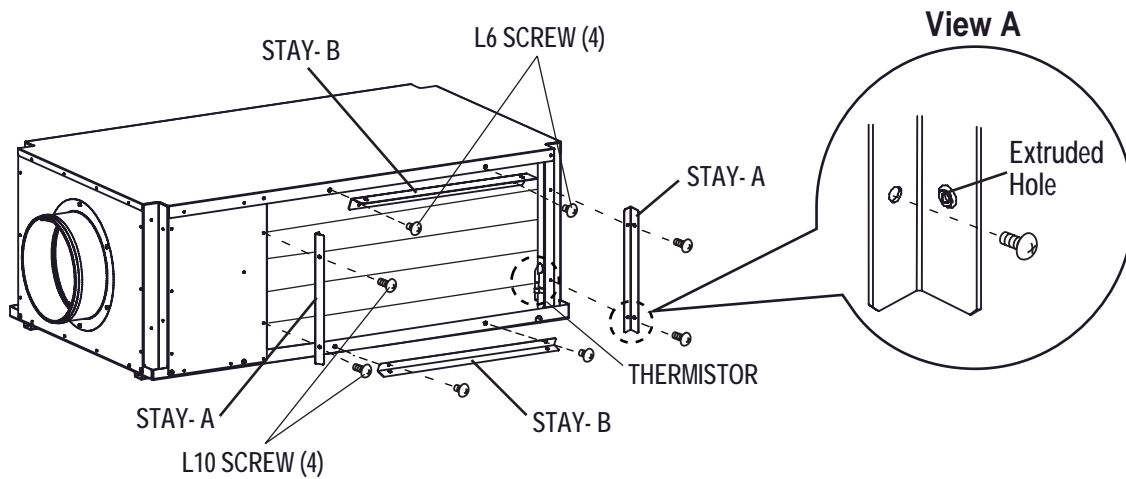

4. Install the assembled air plenum to the installed stays with the supplied eight (8) screws.

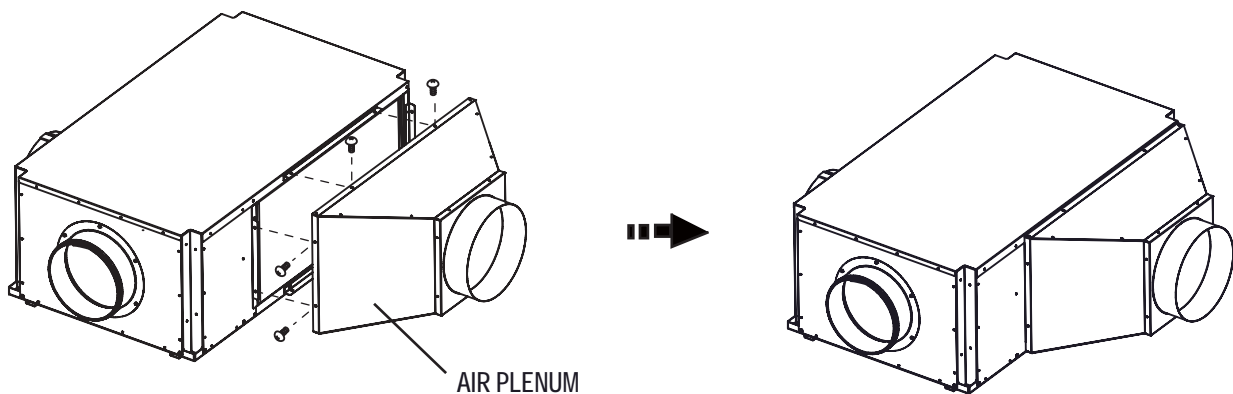

CLEANING CONDENSER AIR INTAKE

Inspect and remove dust buildup on the condenser air intake of the CM 25 with a vacuum cleaner periodically to prevent insufficient cooling.