

SUBMITTAL DATA



SET & SETU

POSITIVE PRESSURE SERIES GAS FIRED INFRA-RED TUBE HEATERS

PROJECT:	
ENGINEER:	
CONTRACTOR:	
DISTRIBUTOR:	
SCHWANK MODEL #:	
FUEL:	N.G. L.P.G
APPROVED BY:	
DATE:	
APPROVAL #:	

NOTICE:

Schwank reserves the right to make changes to equipment and specifications without obligation or notification.

This publication, or parts thereof, may not be reproduced in any form, without prior written consent from Schwank. Unauthorized use or distribution of this publication is strictly prohibited.

Schwank
5285 Bradco Blvd.,
Mississauga, Ontario,
L4W 2A6

2 Schwank Way
Waynesboro, Georgia,
USA 30830

Customer and Technical Services
Phone: 1-877-446-3727 Email: csr@schwankgroup.com
Fax : 1-866-361-0523
www.schwankgroup.com



QTY ON PROJECT	TABLE 1: MODEL CONFIGURATIONS	OVERALL HEATER LENGTH	BTU/HOUR INPUT	TURBULATOR REQUIRED LENGTH	GAS PRESSURE & ELECTRICAL	SHIPPING WEIGHT (LBS.)	
	SET 200/140-60*	59' 8"	200,000 Btu/hr 59 Kw	10'	<u>LINE</u> <u>MINIMUM</u> 5" (127 mm) W.C. N.G. 11" (279 mm) W.C. L.P.	210	
	SET 200/140-50*	50' 0"		10'		180	
	SETU 200/140-30*	31' 11"		10'		210	
	SET 175/125-60*	59' 8"	175,000 Btu/hr 51 Kw	10'		210	
	SET 175/125-50*	50' 0"		10'		180	
	SETU 175/125-30*	31' 11"		10'		210	
	SET 155/110-50	50' 0"	150,000 Btu/hr 44 kW	Not Required	<u>LINE</u> <u>MAXIMUM</u> 14" (356 mm) W.C. N.G. 14" (356 mm) W.C. L.P.	180	
	SET 155/110-40	40' 4"		10'		150	
	SETU 155/110-30	31' 11"		Not Required		210	
	SETU 155/110-20	22' 3"		10'		150	
	SET 130/90-40	40' 4"	125,000 Btu/hr 37 kW	10'		150	
	SET 130/90-30*	30' 8"		14'		120	
	SETU 130/90-20	22' 3"		10'		150	
	SETU 130/90-15*	17' 3"		14'		120	
	SET 110/75-40	40' 4"	110,000 Btu/hr 32 kW	10'		<u>MANIFOLD</u> 3.5" (89 mm) W.C. N.G. 10" ((254 mm) W.C. L.P. 1/2" (13 mm) INLET	150
	SET 110/75-30	30' 8"		14'			120
	SETU 110/75-20	22' 3"		10'	150		
	SETU 110/75-15	17' 3"		14'	120		
	SET 80/60-30	30' 8"	80,000 Btu/hr 23 kW	14'	ELECTRICAL 120V, 60 HZ		120
	SET 80/60-20	21' 0"		14'			90
	SETU 80/60-15	17' 3"		14'			120
	SETU 80/60-10	12' 7"		14'			90

NOTES:

* These Models are available in Natural Gas only: SET(U)175/125, SET(U)200/140, and SET 130/90-30, SETU 130/90-15

Series SET and SETU tube kits are supplied with the turbulator(s) installed into the tube(s) of the system where required.

SET STRAIGHT TUBE SYSTEM

TABLE 2: COMPONENT QUANTITIES PER HEATER MODEL	SET 80/60	SET 80/60 110//75 130/90	SET 110/75 130/90 155/110	SET 155/110	SET 175/125 200/140	SET 175/125 200/140
	20'	30'	40'	50'	50'	60'
HEATER QUANTITY ON PROJECT						
10' ALUMATHERM TUBE w/ FLANGE	0	0	0	0	1	1
10' ALUMINIZED TUBE w/ FLANGE	1	1	1	1	0	0
10' ALUMINIZED TUBE	0	0	0	0	1	1
10' STEEL TUBE	1	2	3	4	3	4
10' REFLECTOR	2	3	4	5	5	6
REFLECTOR END CAP	2	2	2	2	2	2
TORCTITE COUPLER	1	2	3	4	4	5
TUBE / REFLECTOR WIRE HANGER	4	6	8	10	10	12
10'(3,048 mm) ALUMINIZED STEEL TURBULATOR	1	1	1	0	1	1
4' (1,219 mm) ALUMINIZED STEEL TURBULATOR	1	1	0	0	0	0

SETU 'U' TUBE SYSTEM

TABLE 2: COMPONENT QUANTITIES PER HEATER MODEL	SET 80/60	SET 80/60 110//75 130/90	SET 110/75 130/90 155/110	SET 155/110	SET 175/125 200/140
	10'	15'	20'	30'	30'
HEATER QUANTITY ON PROJECT					
10' ALUMA-THERM TUBE w/ FLANGE	0	0	0	0	1
10' ALUMINIZED TUBE w/ FLANGE	1	1	1	1	0
10' ALUMINIZED TUBE	0	0	0	0	1
10' STEEL TUBE	1	1	3	5	4
5' STEEL TUBE	0	2	0	0	0
10' REFLECTOR	1	2	2	3	3
5' REFLECTOR	0	2	0	0	0
REFLECTOR END CAP	2	2	2	2	2
TORCTITE COUPLER	2	4	4	6	6
TUBE / REFLECTOR WIRE HANGER	2	4	4	6	6
10' ALUMINIZED STEEL TURBULATOR	1	1	1	1	1
4' ALUMINIZED STEEL TURBULATOR	1	1	0	0	0
180 DEGREE TURN-AROUND BOX	1	1	1	1	1

TABLE 3: APPROVED MINIMUM CLEARANCES TO COMBUSTIBLES

MODEL SET(U) / ITT(U) "Straight" & "U-Tube"	HORIZONTAL			ANGLE UP TO 45 DEGREES			
	TOP	SIDE	BELOW	TOP	REAR	FRONT	BELOW
	A inches (cm)	S inches (cm)	C inches (cm)	D inches (cm)	B inches (cm)	F inches (cm)	C inches (cm)
200,000/140,000	7"	22"	68"	7"	1"	57"	68"
175,000/125,000	6.5"	20"	68"	6.5"	1"	47"	68"
155,000/110,000	6"	19"	64"	6"	1"	44"	64"
130,000/90,000	4"	11"	60"	5"	1"	35"	56"
110,000/75,000	3"	10"	60"	4.5"	1"	26"	54"
80,000/60,000	2.5"	6"	42"	3.5"	1"	23"	38"

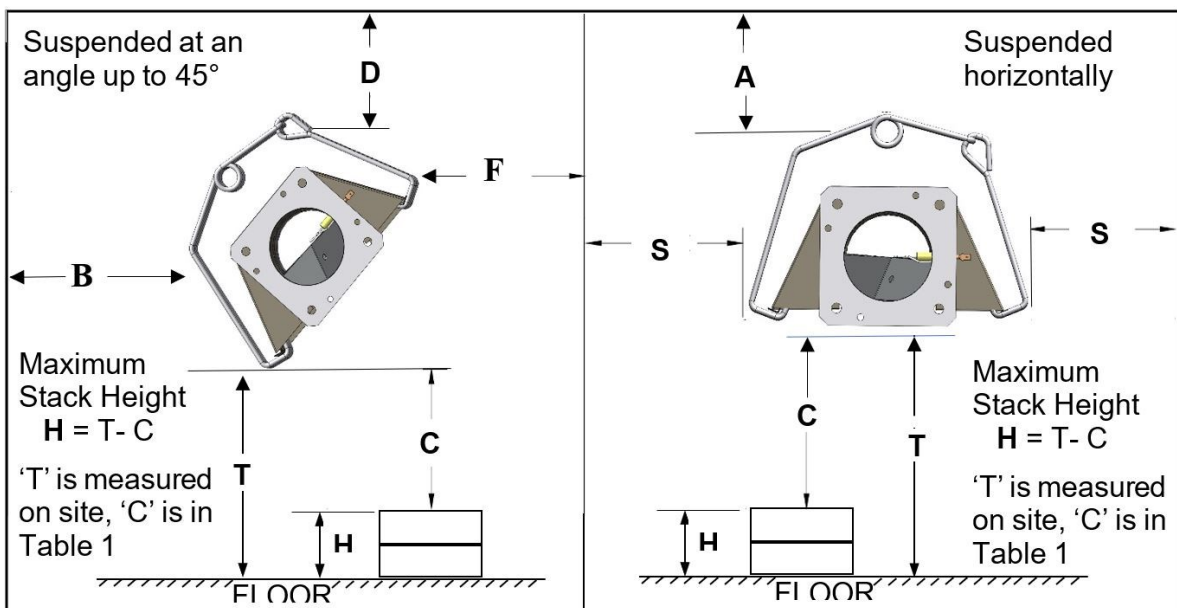

SECTION DETAILS—STRAIGHT TUBE

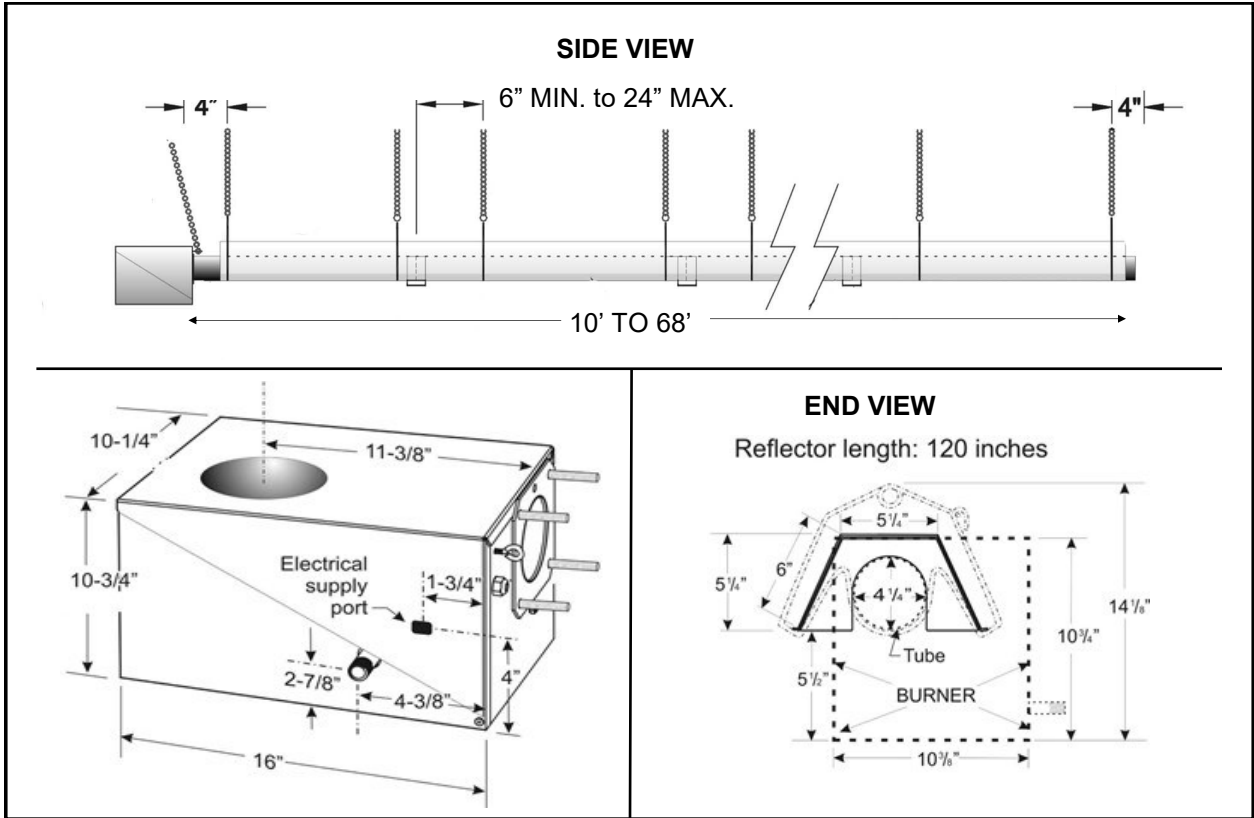

SECTION DETAILS—'U' TUBE

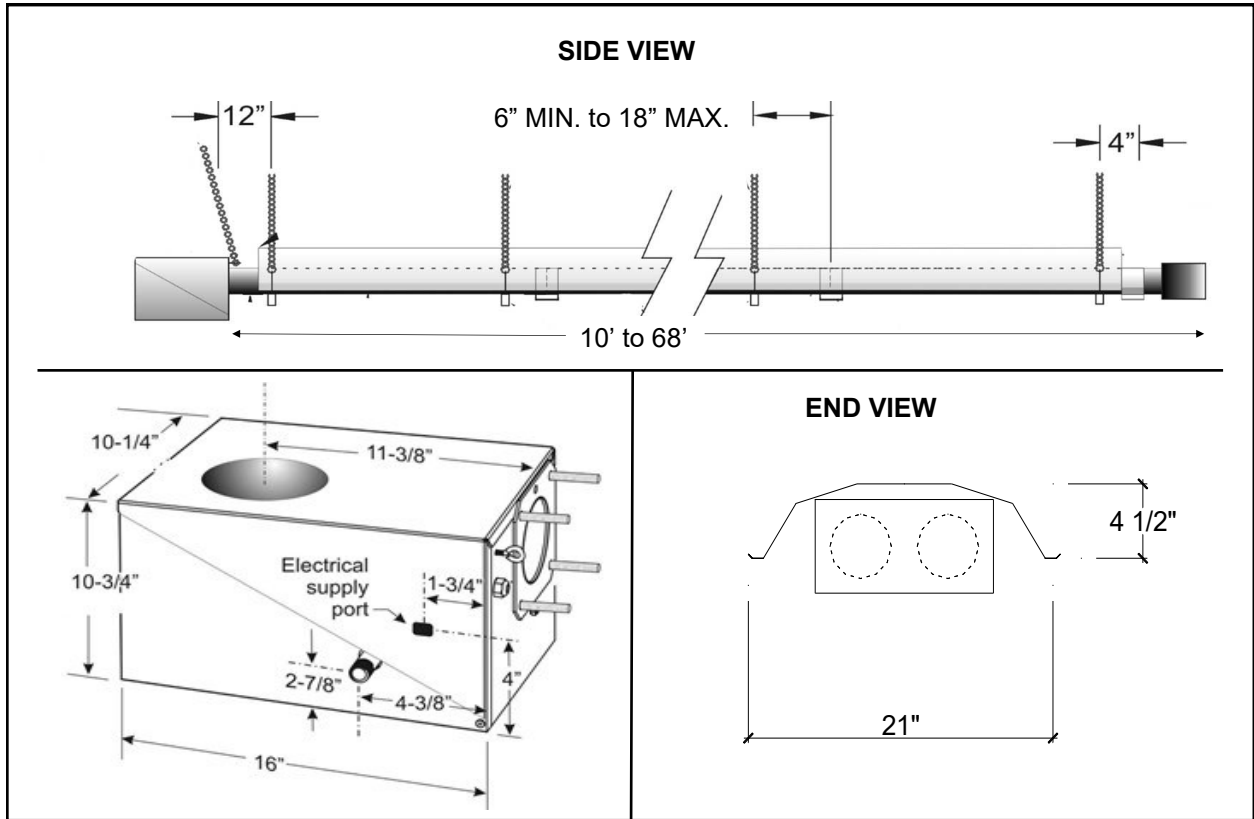

TOP VIEWS OF SYSTEMS

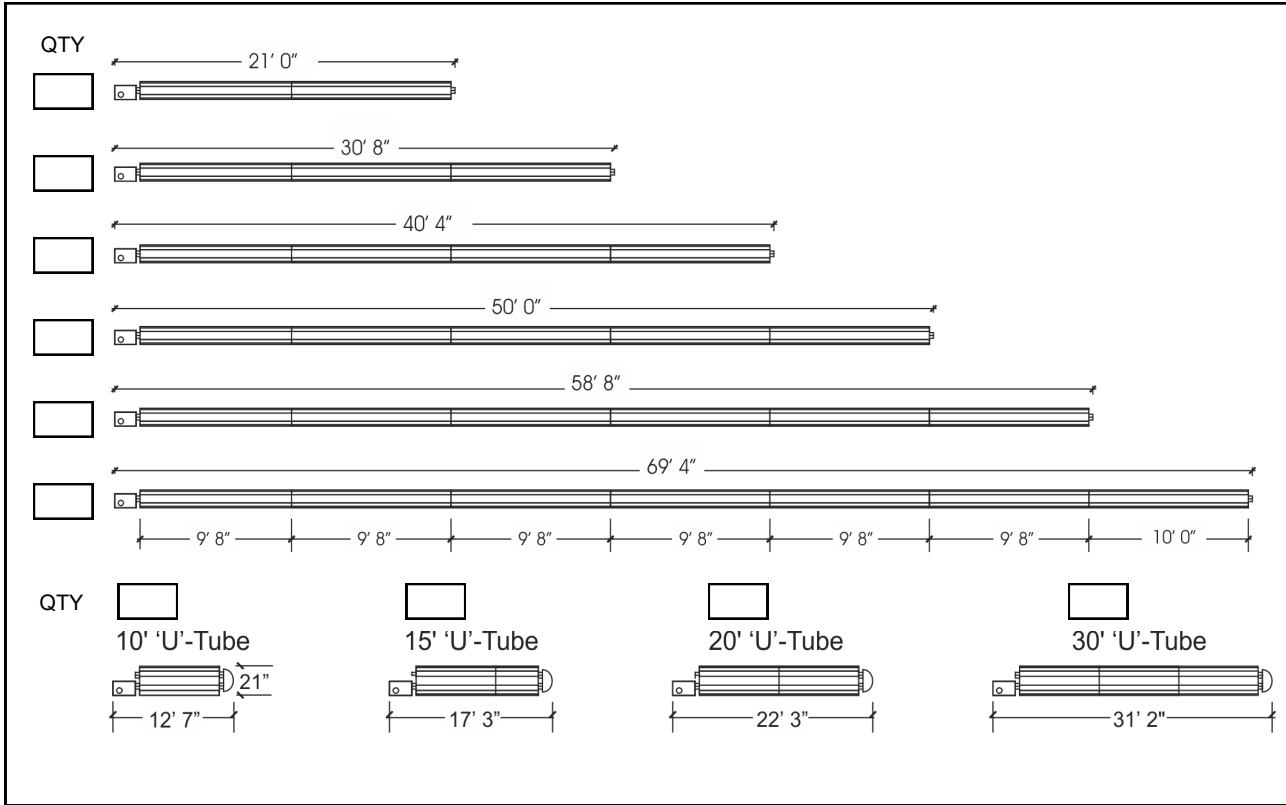

CUT-AWAY BURNER VIEW

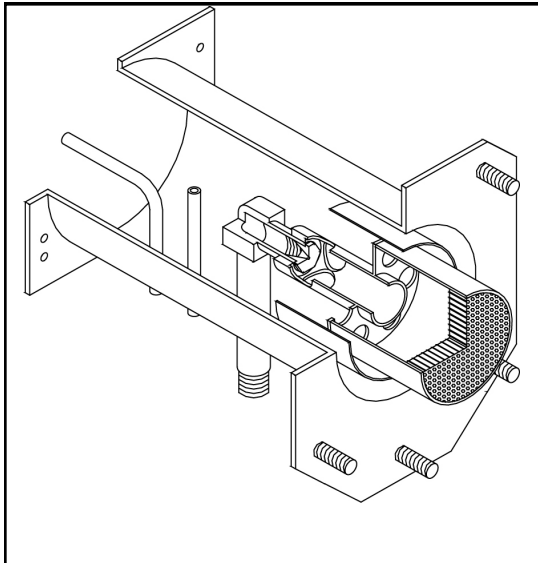

OPTIONAL ACCESSORIES	PROJECT QTY
90 DEGREE ELBOW KIT JS-0508-SM 1 ELBOW, 2 REFLECTOR END CAPS, 1 CLAMP.	
4" FRESH AIR INTAKE CAP JS-0532-VC	
4" WALL FLUE VENT TERMINAL JA-0528-XX	
FLUE VENT TEE (4" x 4" x 6") JA-0514-AA	
#2 LION CHAIN—200 FT ROLL JL-0800-XX	
2" SAFETY SNAP HOOKS: PKG of 24 JL-0800-SH	
THERMOSTAT 2 STAGE 24V DIGITAL JS-0569-DT	
NOTE: 2 Stage thermostat control for multiple heaters: Requires: Qty 2 x JS-0568-CC for each thermostat + Qty 2 x JS-0568-CC for each heater	

COMPONENT SPECIFICATIONS

IGNITION	FENWAL DIRECT SPARK MODULE: PRE-PURGE AND POST-PURGE OF TUBE SYSTEM
THERMOSTAT OPTIONS <i>(Factory ready for 24Vac or 120Vac control)</i>	HONEYWELL FocusPRO TH5000 Series THERMOSTAT - 2 STAGE 24VAC DIGITAL NOTE: MULTIPLE HEATERS PER 24V THERMOSTAT REQUIRE RELAYS JS-0568-CC
	THERMOCONTROL PLUS 2-STAGE CONTROLLER
ELBOWS	90 DEGREE ELBOW 4" DIAMETER, 16 GA. ALUMINIZED STEEL, SWAGED ONE END
	180 DEGREE ALUMINIZED STEEL TURN-AROUND BOX WITH ONE SWAGED END. (SETU Series)
HEATER TUBE(S) 80 to 155 MBH	COMBUSTION TUBE: FLANGED 10' x 4" (DIAMETER 16 GA. ALUMINIZED STEEL SWAGED ONE END SECOND TUBE: 10' x 4" (3048mm X 102mm) DIAMETER 16 GA. ALUMINIZED STEEL SWAGED ONE END EACH ADDITIONAL TUBE: 10' x 4" DIAMETER, .16 GA. STEEL TUBES WITH HIGH TEMPERATURE EMISSIVE COATING, SWAGED ONE END
HEATER TUBE(S) 175 & 200 MBH	COMBUSTION TUBE: 10' x 4" DIAMETER, 16 GA. 439 STAINLESS STEEL SWAGED ONE END SECOND TUBE: 10' x 4" DIAMETER, 16 GA. ALUMINIZED STEEL SWAGED ONE END EACH ADDITIONAL TUBE: 10' x 4" DIAMETER, 16 GA. STEEL WITH HIGH TEMPERATURE EMISSIVE COATING SWAGED ONE END
COMBINATION GAS VALVE	HONEYWELL 24 VOLT NATURAL GAS: 3.5" / 1.7" W.C. MANIFOLD PROPANE: 10" / 4.9" W.C. MANIFOLD
GAS CONNECTION	USA: FLEXIBLE STAINLESS STEEL GAS CONNECTOR REQUIRED BY CODE: SUPPLIED WITH BURNER
	CANADA: TYPE 1 GAS HOSE CONNECTOR REQUIRED BY CODE: SUPPLIED WITH BURNER
REFLECTORS	26 GA. ALUMINIZED STEEL REFLECTOR 10 FT LENGTH OVERLAP ENTIRE LENGTH OF SYSTEM; SETU x 15 FT MODEL INCLUDES ONE x 10 FT AND ONE x 5 FT REFLECTOR
	REFLECTORS ARE CLOSED AT START AND END OF EACH STRAIGHT RUN OF TUBES BY MEANS OF END CAPS
HANGERS	TWO 1/4" PLATED WIRE HANGERS SUPPORT EACH LENGTH OF TUBE / REFLECTOR
COUPLING KIT	ALUMINIZED STEEL COUPLER; STAINLESS STEEL COUPLER FIRST TUBE CONNECTION 175 & 200 MBH
BURNER HOUSING	BOTTOM FOLDS AWAY, PROVIDING ACCESS FROM TWO SIDES, END AND BOTTOM
BURNER	INCORPORATES EFFECTILE CERAMIC BURNER HEAD WITH MINIMUM OF 835 FLAME PORTS
	COMPLETE WITH OPERATION STATUS INDICATOR LIGHTS
TRANSFORMER	120/24VAC; 20VA
SAFETY SWITCHES	TWO SEPARATE AIR PRESSURE SWITCHES SENSE ADEQUATE COMBUSTION AIR AND BLOCKED FLUE
COMBUSTION AIR	COMBUSTION AIR DUCTED DIRECTLY TO 4" COLLAR AT INTAKE OF BLOWER
TERMINAL BLOCK	ALL WIRING CONNECTIONS BY MEANS OF COMMON TERMINAL BLOCK;
VENT PIPE	ALL VENT PIPE IS FIELD SUPPLIED BY OTHERS; SINGLE WALL VENT PIPE OTHER THAN PORTION THROUGH WALL OR ROOF MAY BE DOUBLE WALL VENT PIPE
ROOF VENT CAPS	FIELD SUPPLIED BY OTHERS TO MATE WITH VENT PIPE