

JS-0555-XA CONVERSION KIT INSTRUCTIONS

40,000 BTU/hr NG TO LP – Schwank Models: P40R-FA; P40U-FA; P40U-P-FA; P40U-W-FA
Infrasave Models: P40R-FA; P40U-I-FA; P40U-IP-FA; P40U-IW-FA

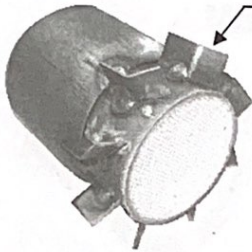

-FA Model Burner Cup

Note: -FA Model has a steel burner cup with vanes

Model with aluminum burner cup see next page. ←

Exploded diagram of the burner assembly Page 3.



TOOLS REQUIRED:

- 1/2" Deep Socket Wrench with 6" extension
- 1/4" Nut Driver
- Green Nut Driver 11/32"
- Red Robertson Screwdriver #2
- 3/16" Allen Wrench

Refer to the General Instructions and Valve Conversion Instructions that accompany this kit.

The gas supply shall be shut off prior to disconnecting the electrical power, before proceeding with the conversion

- Remove the 4 **Flange Nuts** from the Burner
DO NOT REMOVE THE BOTTOM / LOWEST 5th NUT
- Unscrew the **Burner Cup** in a counter clockwise rotation. Use caution not to damage the ceramic component of the Burner Cup face.
- **-FA MODEL ONLY:** Adjust **Air Restrictor Ring** on burner cup to the fully open position
 - Remove the 2 retaining screws that hold the **Air Restrictor Ring** in place
 - Rotate **Air Restrictor Ring** so that holes in the Restrictor Ring align with holes in Burner Cup = fully open position
 - Reinstall the 2 screws to fasten the Ring in place
- Remove the **Main Burner Orifice** with an extended 1/2" socket wrench. Discard the **NG Main Burner Orifice size 31 DMS** and replace it with the new **LP Main Burner Orifice size 49 DMS**. Please be aware that the LP orifice has a smaller hole than the NG orifice.
- Re-install the **Burner Cup** with a clockwise rotation – use care do not cross thread. Do not over tighten the Burner Cup – hand tight firm is sufficient.
- Refer to **Honeywell Instruction sheet** to convert the **Combination Gas Valve**:
 - Remove & discard the **Silver Pressure Regulator Cap Screw** and **O-Ring**.
 - Remove & discard the **Adjusting Screw** and **Stainless Steel Spring**.
 - From the Valve Conversion Kit supplied, install the new **Red Adjustment Spring**, and **Adjusting Screw**, setting it almost to the bottom.
 - Using a manometer, check the manifold gas pressure with the heater turned on. Regulate the manifold gas pressure to **10" w.c.** by turning the **Adjusting Screw** clockwise to increase, and counter clockwise to reduce the pressure.
 - Install new **O-Ring** and **Silver Pressure Regulator Cap Screw** provided.
- Affix **Valve Conversion Sticker** to the valve.
- Print Date, Company Name & Address on **Conversion Kit Rating Plate** and affix the plate to the heater in the proximity of the CSA rating plate

Return to General Instructions and complete all steps of leak testing and commissioning.

JS-0555-XA CONVERSION KIT INSTRUCTIONS

40,000 BTU/hr NG TO LP:

Model with Aluminum Burner Cup

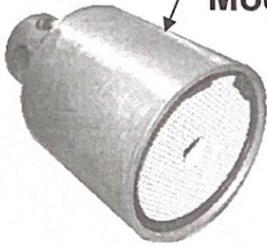

Steel burner cup with vanes see previous page. ←

Exploded diagram of the burner assembly next page.



TOOLS REQUIRED:

- 1/2" Deep Socket Wrench with 6" extension
- 1/4" Nut Driver
- Green Nut Driver 11/32"
- Red Robertson Screwdriver #2
- 3/16" Allen Wrench

Refer to the General Instructions and Valve Conversion Instructions that accompany this kit.

Exploded diagram of the burner assembly on next page.

The gas supply shall be shut off prior to disconnecting the electrical power, before proceeding with the conversion

- Remove the 4 Flange Nuts from the Burner
DO NOT REMOVE THE BOTTOM / LOWEST 5th NUT
- Unscrew the **Burner Cup** in a counter clockwise rotation. Use caution not to damage the ceramic component of the Burner Cup face. **NOTE: -FA Model (steel burner cup with vanes) requires adjustment of Air Restrictor Ring – see previous page.**
- *No adjustment of the Air Restrictor Ring is required on the Aluminum Burner Cup*
- Remove the **Main Burner Orifice** with an extended 1/2" socket wrench. Discard the **NG Main Burner Orifice size 31 DMS** and replace it with the new **LP Main Burner Orifice size 49 DMS**. Please be aware that the LP orifice has a smaller hole than the NG orifice.
- Re-install the **Burner Cup** with a clockwise rotation – use care do not cross thread. Do not over tighten the Burner Cup – hand tight firm is sufficient.
- **Refer to Honeywell Instruction sheet to convert the Combination Gas Valve:**
 - Remove & discard the **Silver Pressure Regulator Cap Screw** and **O-Ring**.
 - Remove & discard the **Adjusting Screw** and **Stainless Steel Spring**.
 - From the Valve Conversion Kit supplied, install the new **Red Adjustment Spring**, and **Adjusting Screw**, setting it almost to the bottom.
 - Using a manometer, check the manifold gas pressure with the heater turned on. Regulate the manifold gas pressure to **10" w.c.** by turning the **Adjusting Screw** clockwise to increase, and counter clockwise to reduce the pressure.
 - Install new **O-Ring** and **Silver Pressure Regulator Cap Screw** provided.
- Affix **Valve Conversion Sticker** to the valve.
- Print Date, Company Name & Address on **Conversion Kit Rating Plate** and affix the plate to the heater in the proximity of the CSA rating plate

Return to General Instructions and complete all steps of leak testing and commissioning.

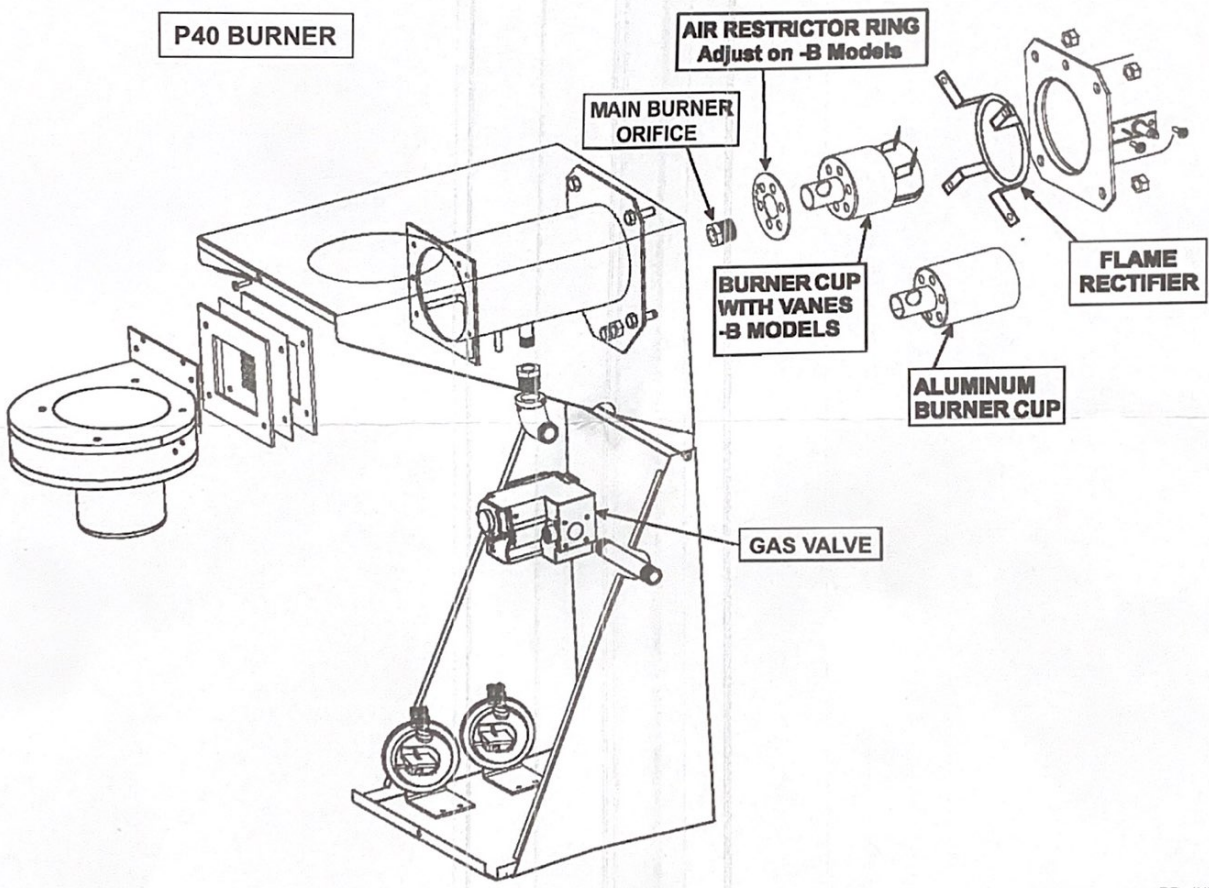

RD: JUNE, 2015
RL: 3B