



CB-2 DrainDawg™ Instructions

The DrainDawg™ condensate drain line cleaning kit uses dry nitrogen or CO₂ to clear drain line clogs. The DrainDawg may also be used for other uses including removing dirt from HVAC coils, purging of a system with dry nitrogen at low flow, inflating tires and more. Purging and pressure testing a system is only recommend with dry nitrogen. CO₂ is not recommended. Make note of which type of gas is being used in that application.

Pressure Regulation

1. Connect the DrainDawg regulator to the outlet of the nitrogen or CO₂ cylinder. This connection should be wrench tight.
2. Connect the DrainDawg blue hose to the outlet ¾ SAE fitting on the DrainDawg pressure regulator. This connection should be hand tight.
3. Prior to opening the parent tank valve, make sure the pressure regulator handle is backed out by turning it counterclockwise.
4. Open the parent tank valve. Do not exceed 3000psi inlet pressure as this is the maximum rating of the regulator. Ensure there are no leaks. Attach desired accessory to the other end of the blue house. Ensure this connection is hand tight.
5. Set the pressure of the DrainDawg by regulating the pressure to the desired setting by turning the pressure regulator handle clockwise. Do not exceed the pressure rating for the desired accessory being used.

Warnings

- Caution: cylinders are highly pressurized. Always handle with care. Never allow cylinders to be dropped, knocked over or subjected to excessive heat.
- Never stand in front of or behind a regulator or tank when opening the cylinder valve. Always stand so that the cylinder is between you and the regulator.
- Do not use the regulator if there are any damaged parts on the regulator, cylinder, or valve.

Included Accessories



CK-141

The CK-141 can be used with other pipe sizes that may not work with the DF-75. To use this accessory, connect the stationary fitting end of the CW-15 red hose to the end of the blow gun and the rotatable fitting end of the CW-15 red hose to the CK-141. Do not exceed 100psi. CO₂ or Nitrogen may be used.

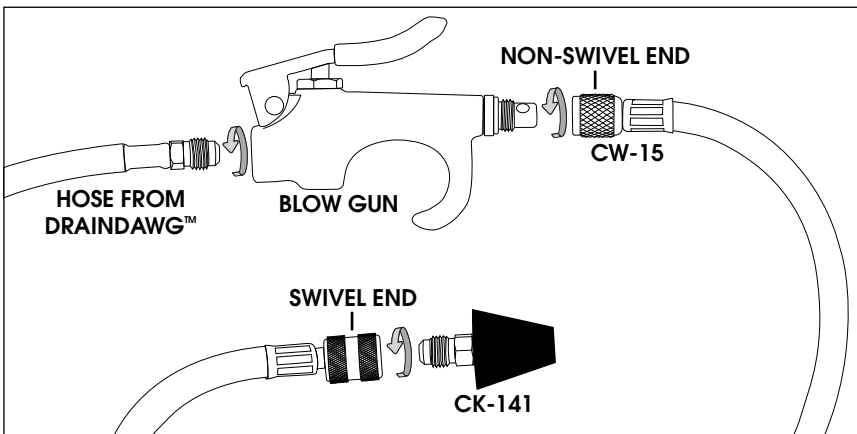

Included Accessories (cont.)



DF-75 DrainDawg

This inflatable fitting can be used to clear clogs in drain pipes. To use this accessory, connect the stationary fitting end of the CW-15 red hose (whip hose) to the end of the blow gun and the rotatable fitting end of the CW-15 red hose to the DF-75. Do not exceed 140psi with DF-75. The DF-75 should only be used with 3/4"-1" diameter pipe.

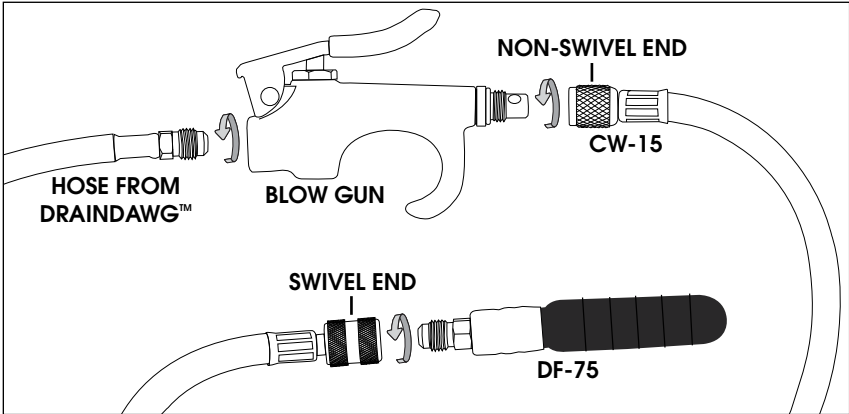

When using the DrainDawg accessory to clear a drain line, be sure to insert the DrainDawg fully into the pipe.

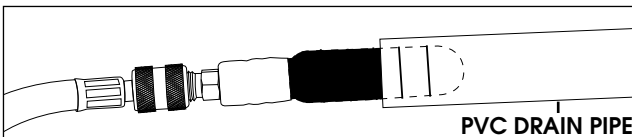
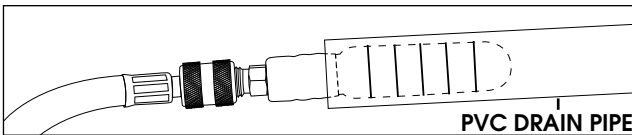

FA-02

The FA-02 fitting is used to connect a CO₂ cylinder to the DrainDawg™ regulator. Simply screw on the FA-02 fitting to the CO₂ cylinder, then attach the DrainDawg™ regulator to the other end.

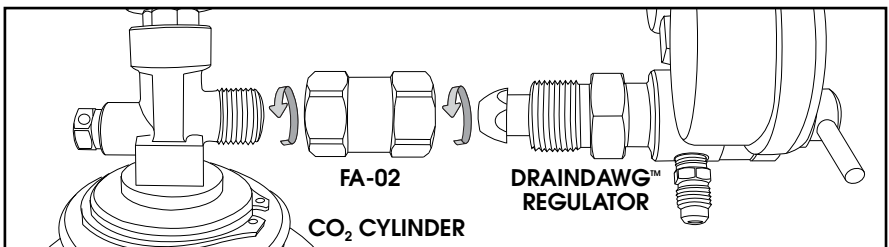

Included Accessories (cont.)



QN-S3

This accessory is used to blow compressed dirt and debris from a coil. To use this accessory, attach the QN-S3 to the end of the blow gun. Do not exceed 30psi. CO₂ or Nitrogen may be used.

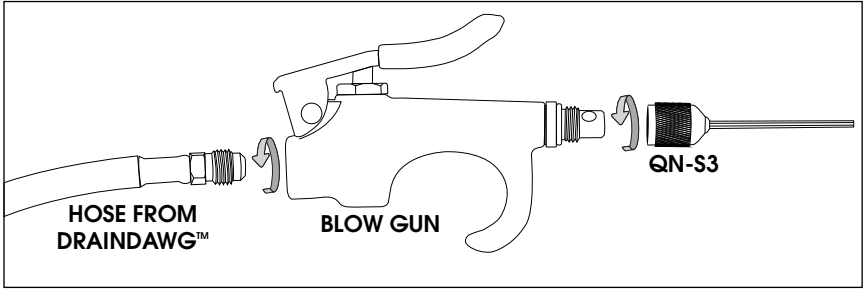

TC-25

This accessory can be used to pressure test a system or inflate a tire. To use this accessory, connect the stationary fitting end of the CW-15 red hose to the end of the blow gun and the rotatable end of the CW-15 red hose to the TC-25. Only dry Nitrogen is recommended. Do not exceed 400psi.

