

# PRODUCT INFORMATION PACKET



Model No: B2977  
Catalog No: B2977  
1.5-.20 HP Pool Pump Motor, 1 phase, 3600 RPM, 230 V, 56J Frame, ODP  
Pool Pump Motors



Regal and Century are trademarks of Regal Rexnord Corporation or one of its affiliated companies.  
©2021 Regal Rexnord Corporation, All Rights Reserved. MC017097E





**Nameplate Specifications**

Output HP	1.5-.20 Hp	Output KW	1.1 kW
Frequency	60 Hz	Voltage	230 V
Current	SF 8.7-1.9 A	Speed	3450/1725 rpm
Service Factor	1.3	Phase	1
Duty	Continuous	Insulation Class	F
Frame	Y56J	Enclosure	Drip Proof
Thermal Protection	Thermally Protected	Ambient Temperature	50 °C
UL	Recognized	CSA	Y
Number of Speeds	2-2-VT		

**Technical Specifications**

Electrical Type	Psc Low Speed, Cap Start/Cap Run High Speed	Poles	2/4
Rotation	Clockwise	Mounting	Round
Motor Orientation	Horizontal	Drive End Bearing	Ball
Opp Drive End Bearing	Ball	Frame Material	Rolled Steel
Shaft Type	7/16 Threaded	Overall Length	13.05 in
Frame Length	8.00 in	Shaft Diameter	0.625 in
Shaft Extension	2.57 in		
Connection Drawing	D0000026-001.PCX	Outline Drawing	B2977-S01

This is an uncontrolled document once printed or downloaded and is subject to change without notice. Date Created:10/07/2021

4

3

2

1

REV	ECO	REV BY	DATE	APPD	DATE
D	ECR-0212148	D.SURYAWANSHI	09/02/2021		

D

C

B

A

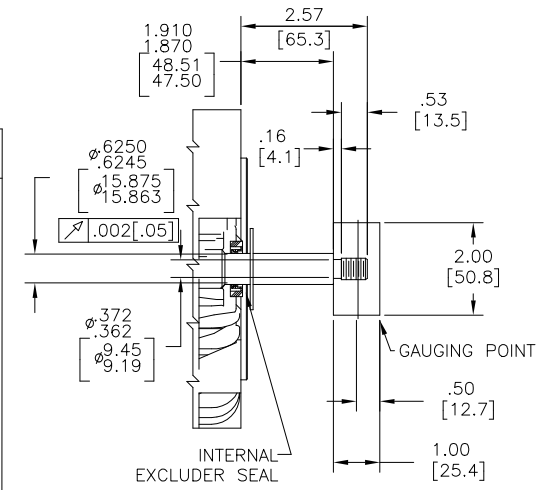
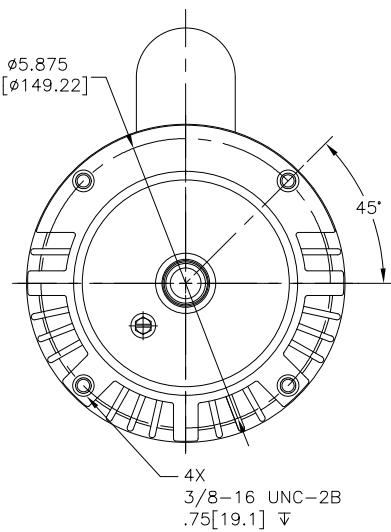
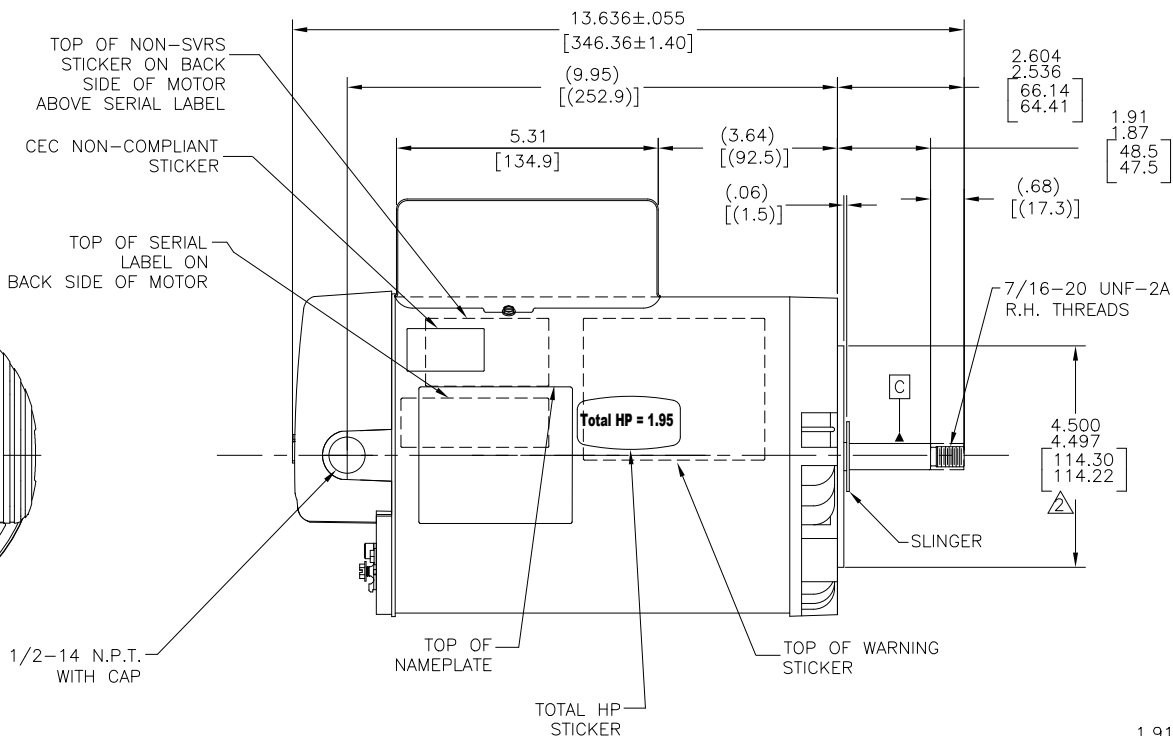
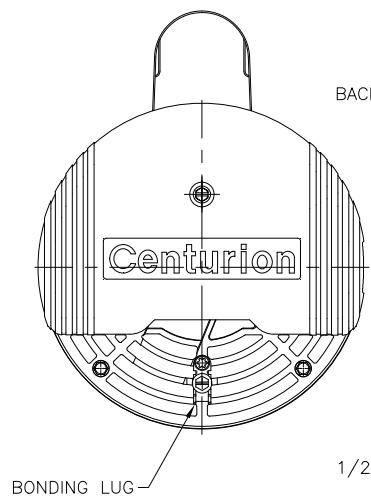

NAMEPLATE DATA	EXTERNAL CONNECTION DIAGRAM	NOTES
MODEL: K56AB45A01 CUST PN: B2977 HP: 1.5-.20 SF: 1.3 ROT: CWLE RPM: 3450/1725 TYPE: CXCP CODE: E FORM: KJM FRAME: Y56J VOLTS: 230 AMPS: 7-1.7 MAX AMPS: SF AMPS: 8.7-1.9 PH: 1 HZ: 60 INS: F AMB: 50°C DUTY: CONT ENCLOSURE: ODP THERMALLY PROTECTED	<p>100-9200000000</p> <p>GRD GREEN (GROUND)</p> <p>USE COPPER CONDUCTORS ONLY</p> <p>INSTALL MOTOR WITH VENTS DOWN</p> <p>ACCEPTABLE FOR FIELD WIRING</p>	1. FOR THREADED SHAFT EXT. ECCENTRICITY OF THREADED PORTION OF SHAFT IS HELD WITHIN .004[.10] TOTAL GAGE READING WITH THE INDICATOR ON O.D. OF GROUND RING GAGE AS SHOWN. THE GAGE BEING STATIONARY WITH RESPECT TO THE ROTOR. 2. END PLAY NOT TO EXCEED .010[.25] MEASURED WITH NO THRUST. 3. ALL DIMENSIONS SHOWN IN PARENTHESIS ARE REFERENCE DIMENSIONS. 4. FINISH PAINT TO BE BLACK. 5. 1.95 SF HP

PERFORMANCE CURVE	APPROVED SAMPLE	GEOMETRIC CHARACTERISTICS & SYMBOLS ▭ FLATNESS / STRAIGHTNESS < ANGULARITY ⊥ PERPENDICULARITY (SQUARENESS) // PARALLELISM ○ ROUNDNESS (CIRCULARITY) ∅ CYLINDRICITY △ PROFILE OF ANY SURFACE ∩ PROFILE OF ANY LINE √ ROUNDT ⊕ TRUE POSITION ⊙ CONCENTRICITY = SYMMETRY	UNLESS OTHERWISE SPECIFIED DIM. TOLERANCES ARE AS FOLLOWS: INCH ±.1 XX ±.005 ±.0005 mm ±0.5 ±0.13 ±0.013 ANG. ±50 DEG REMOVE BURRS & BREAK SHARP EDGES: INCH .003-.015 mm 0.1-0.4 CORNER FILLETS TO: INCH .020 mm 0.5 MACHINE SURFACES: INCH 125 mm 3.2	DR BY: MEO	12-13-2012	<b>REGAL-BELOIT CORPORATION</b>
UL COMPONENT	CSA			APPD: 12-13-2012	12-13-2012	
FILE# E44549	CCN# PRGY2	FILE# LR4642	GUIDE# 4211-01	THIRD ANGLE PROJECTION	FORMAT REV H	SIZE C DWG NO B2977
CUSTOMER	DISTRIBUTION		ASME Y14.5M 1994	CONFIDENTIAL: THIS DRAWING AND ITS INFORMATION ARE THE EXCLUSIVE AND CONFIDENTIAL PROPERTY OF REGAL-BELOIT CORPORATION AND ARE NOT TO BE DISCLOSED, DUPLICATED, DISTRIBUTED OR OTHERWISE USED WITHOUT THE WRITTEN CONSENT OF REGAL-BELOIT CORPORATION. -ALL RIGHTS RESERVED.		SCALE NONE SHEET 1

4

3

2

1