

# Valve

## VB-9223 Series N.C. 2-1/2" thru 3" Screwed End, 2-1/2" thru 6" Flanged End Valves

For Use With: VA-9223; VC-9223; VK-9223; VP-9223; VS-9223, VU-9223

Valve Body Part No.	Size & Port	Packing	Bracket Nut	Valve Repair Kit Includes Packing Stem & Plug Assembly Bottom Gasket	Current Bonnet Assembly* Includes Packing & Bracket Nut	Seat Ring
	Item No.	1	2	3	4	5
VB-9223-0-4-12	2-1/2" Port 12	YBA-651-1	OYBB-225	RYB-922-12	YBA-652	RYB-9213-101-0-12
VB-9223-0-4-13	3" Port 13	YBA-651-1	OYBB-225	RYB-922-13	YBA-652	RYB-9213-101-0-13
VB-9223-0-5-12	2-1/2" Port 12	YBA-651-1	OYBB-225	RYB-922-12	YBA-652	RYB-9213-101-0-12
VB-9223-0-5-13	3" Port 13	YBA-651-1	OYBB-225	RYB-922-13	YBA-652	RYB-9213-101-0-13
VB-9223-0-5-14	4" Port 14	YBA-651-1	OYBB-225	RYB-922-14	YBA-652	RYB-9213-101-0-14
VB-9223-0-5-15	5" Port 15	YBA-651-1	OYBB-225	RYB-922-15	YBA-652	RYB-9213-101-0-15
VB-9223-0-5-16	6" Port 16	YBA-651-1	OYBB-225	RYB-922-16	YBA-652	RYB-9213-101-0-16

\*Direct replacement for old style.

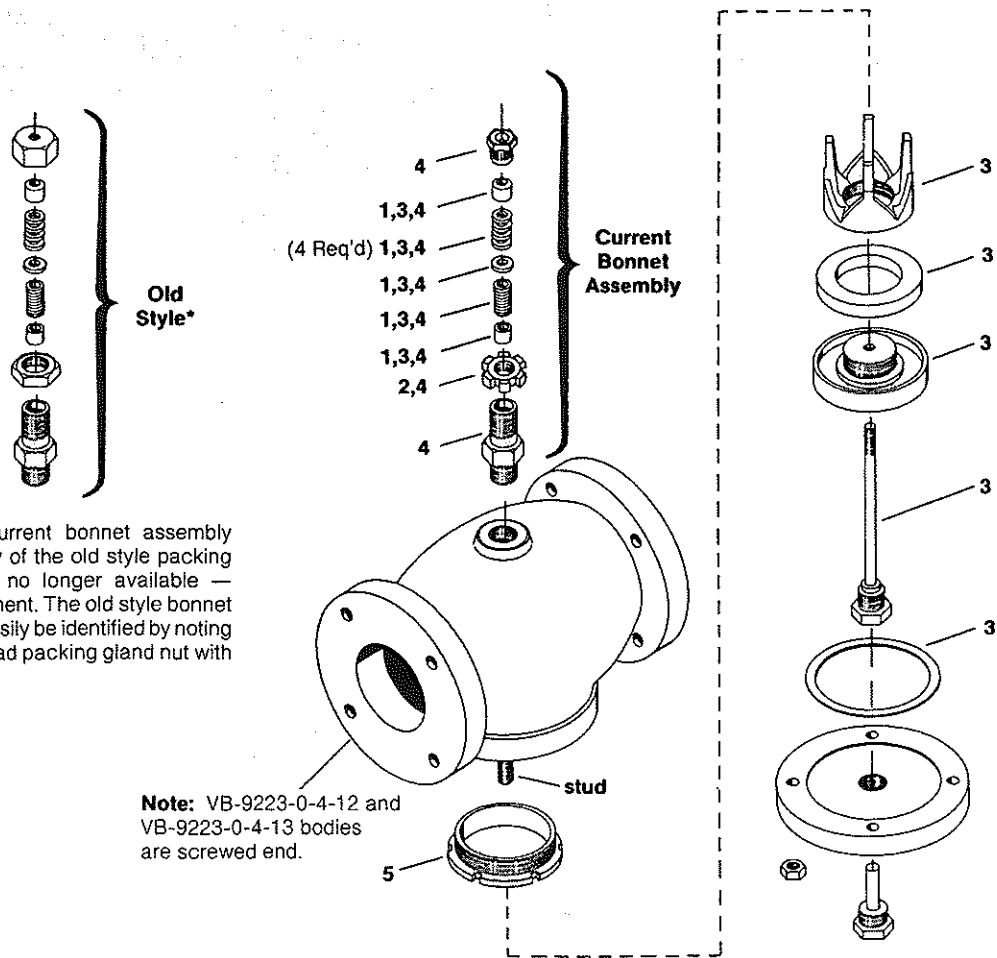

\*Replace with current bonnet assembly (YBA-652) if any of the old style packing components — no longer available — require replacement. The old style bonnet assembly can easily be identified by noting the large hex head packing gland nut with internal threads.

**Note:** VB-9223-0-4-12 and VB-9223-0-4-13 bodies are screwed end.

VB-9223

MAINTENANCE PARTS